

# SOLID SOLUTION DESIGNS

## Projectile Information

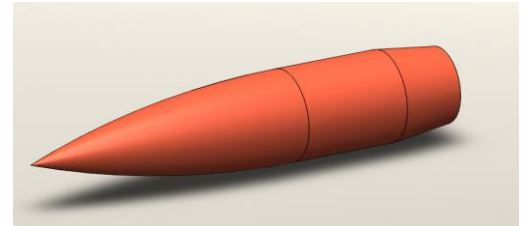

### Name

SSD 236 grain Flying Dutchman

### Caliber & Twistrate

.338 LM, use with 1:10 twist or faster

### Effective range:

2000 m (muzzle velocity : 2700 fps)

2400 m (muzzle velocity : 3000 fps)

### Accuracy to be expected:

'Hole-in-hole' at 100m

### Suggested OAL

The bullet should never be seated deeper than the beginning of the ogive. Also the bullet should not touch the lands and fields of the barrel, in order to prevent overpressure.

### Examples:

.338 Lap Mag

Minimal: 95,8 mm

Maximum: 101,86 mm (should not touch the rifling)

### Suggested Powder

.338 LM Vihtavuori

N160/N170

.338LM Vihtavuori

N560/N570

### Comparison with other bullets

	True BC G1
SSD 236 grain	0.792
Sierra 250 grain HPBT	0.594
Sierra 300 grain HPBT	0.764

### Ballistic Performance (BC G1)

Velocity (m/s)	Velocity (fps)	BC G1
914 – 853 m/s	3000 – 2800 fps	0.77
853 – 792 m/s	2800 – 2600 fps	0.76
792 – 518 m/s	2600 – 1700 fps	0.75
518 – 396 m/s	1700 – 1300 fps	0.70
396 – 304 m/s	1300 – 1000 fps	0.668
304 – 243 m/s	1000 – 800 fps	0.658

### Quickload information

BC G1	0.792	
Weight	236 grain	15,29 g
Length	42,90 mm	1.689"
Velocity band	2650-3000 fps	807 – 914 m/s

### Rifle: .338 LM Barrel: 27 inch Twist: 1 in 9,3"

Primers: Large Rifle Magnum

Cases: Lapua, trim-to length 69,00 mm (2.714")

	OAL	Powder	Velocity	Velocity
.338 LM <sup>1</sup>	95,8 mm	79.0 gr N560	2667 fps	812 m/s
.338 LM	101,4 mm	83.5 gr N560	2870 fps	874 m/s
.338 LM <sup>2</sup>	95,8 mm	86,5 gr N570	2643 fps	805 m/s
.338 LM <sup>3</sup>	95,8 mm	89.0 gr N570	2953 fps	900 m/s
.338 LM	101,5 mm	94.0 gr N570	2959 fps	901 m/s

### Rifle: .338 LM Barrel: 27 inch Twist: 1 in 10"

Primers: Large Rifle Magnum

Cases: Lapua, trim-to length 69,00 mm (2.714")

	OAL	Powder	Velocity	Velocity
.338 LM	97 mm	90.0 gr N560	2962 fps	903 m/s

<sup>1</sup> Accuracy load

<sup>2</sup> Accuracy load

<sup>3</sup> Accuracy load