

SOLID SOLUTION DESIGNS

Projectile Information

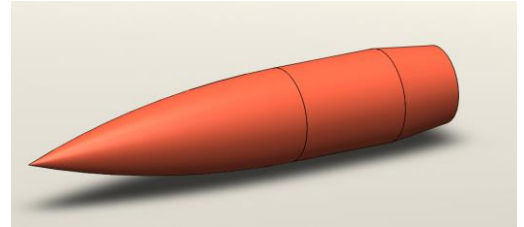

Name

SSD 219 grain Limit-Less

Caliber & Twistrate

.30 / .300 calibers, use with 1:8 twist or faster

Effective range:

2.000 m (muzzle velocity : 914 m/s or 3000 fps)

Accuracy to be expected:

'hole-in-hole' at 100m, use the SSD Field Test Plan to obtain best accuracy

Suggested OAL

The bullet should never be seated deeper than the beginning of the ogive. Also the bullet should not touch the lands and fields of the barrel, in order to prevent overpressure.

.300 RUM

Minimal: 96,89 mm

Maximum: 105,00 mm (should not touch the rifling)

Suggested Powder

.300 RUM Vihtavuori

N560/N570

Comparison with other bullets

	True BC G1
SSD 219 grain (at 941 m/s or 3087 fps)	0.888
Berger 230 grain Match Hybrid	0.754
Berger 215 grain Match Hybrid	0.696
Sierra 210 grain HPBT MK	0.598

Quickload information

BC G1	0.888	
Weight	219 grain	14,19 g
Length	47,70 mm	1.878"
Velocity band	2800-3000 fps	853 – 914 m/s

Rifle: .300 RUM Barrel: 30 inch Twist: 1 in 8"

Primers: Large Rifle Magnum

Cases: Lapua, trim-to length 72.39 mm (2.85")

	OAL	Powder	Velocity	Velocity
.300 RUM	102.69	86.0 gr N570	3046 fps	928 m/s
.300 RUM	97.0	87.0 N570	2998 fps	914 m/s